

**^ZIMUT**

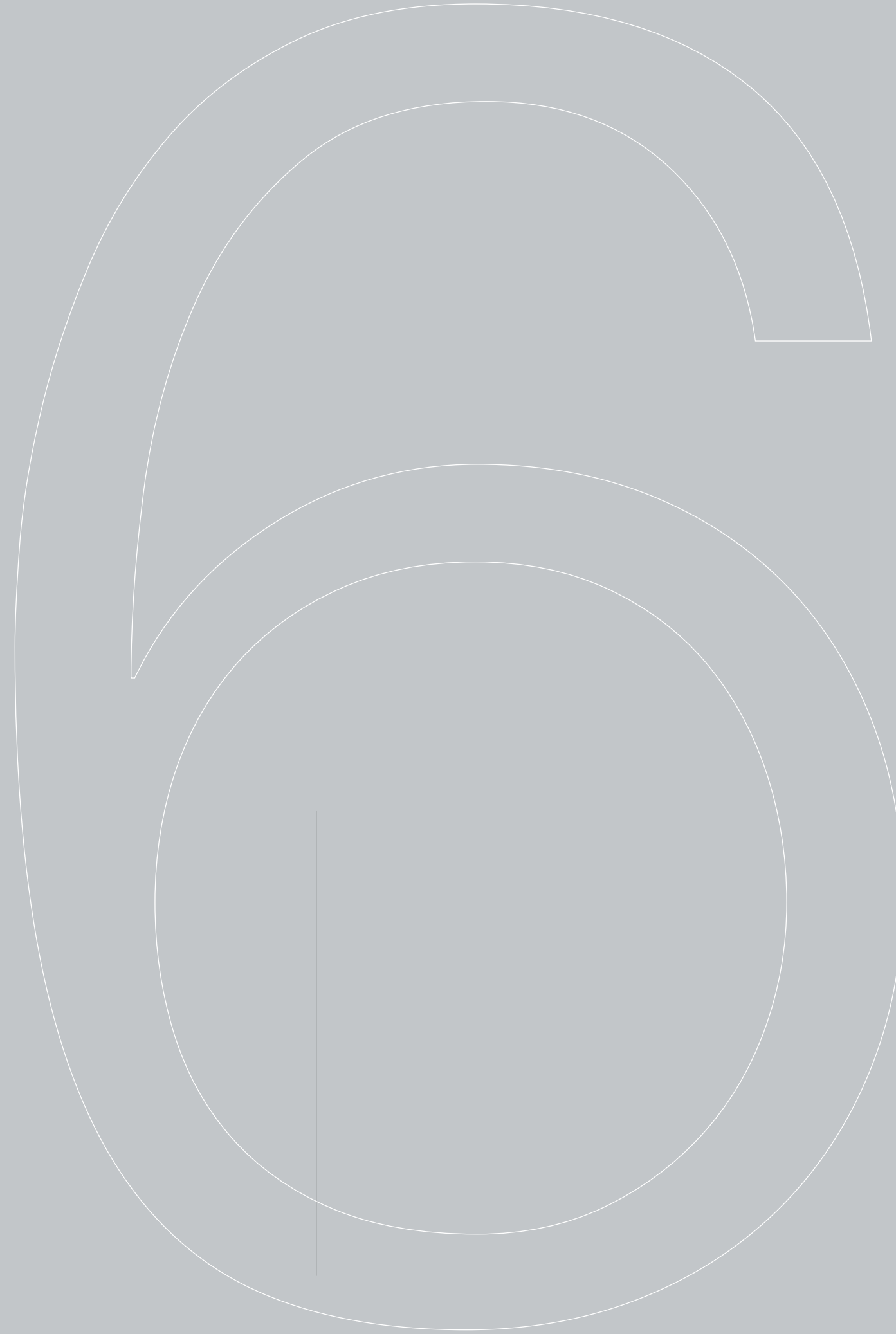

**FLY 60**

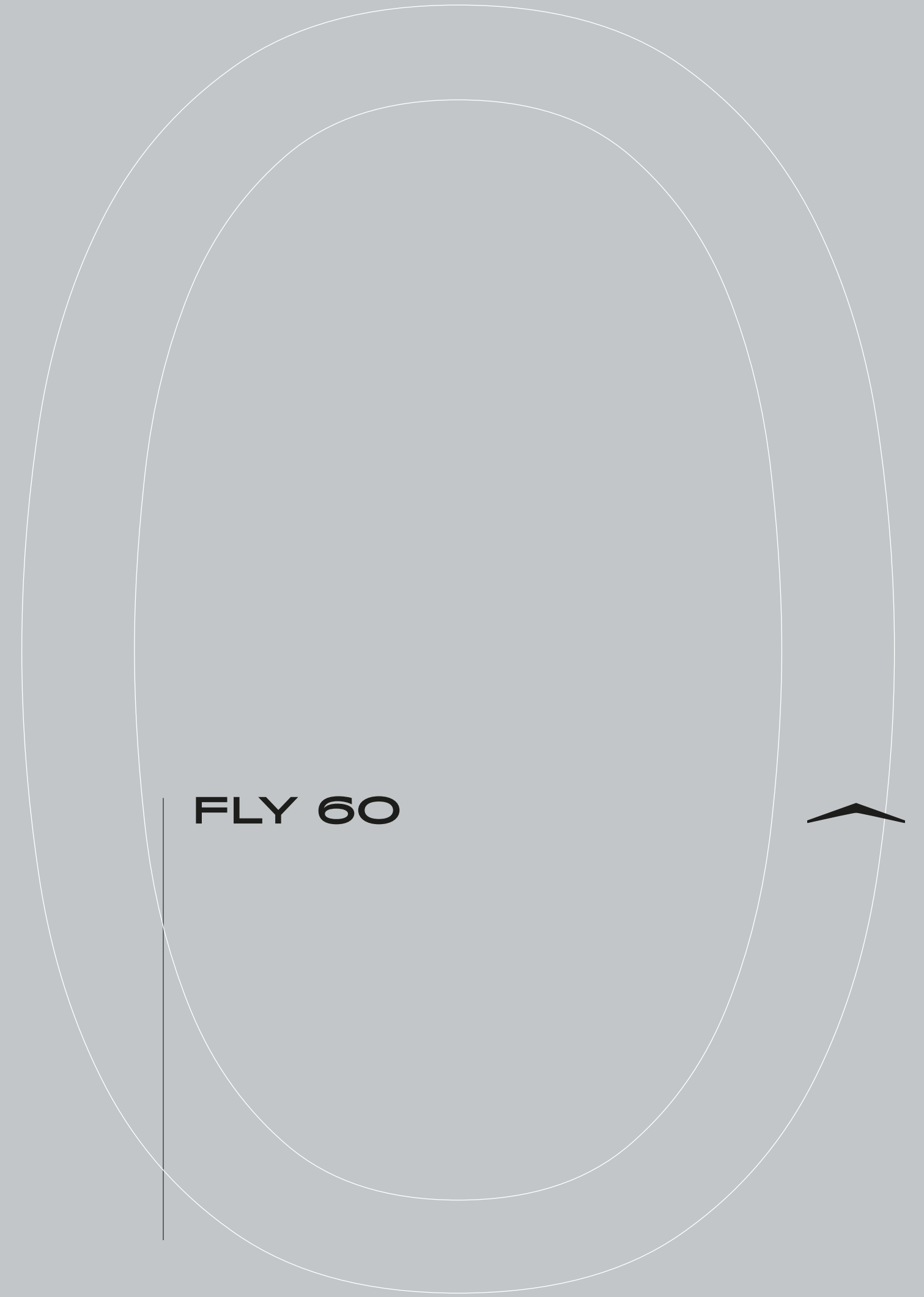

# INDEX

01	THE DESIGN & LIFESTYLE ON BOARD	P04
02	HER MAIN TECHNICAL FEATURES	P30
03	FLY 60 SPEC SHEET	P35
04	THE FLY SERIES	P40
05	ABOUT AZIMUT	P42



A one-of-a-kind beauty, enrapturing, that steals your breath away, leaving you speechless. An extraordinary idea as the only possible pathway, to get to where you want, to explore, to go beyond.

The freedom of embracing the unknown, that you know you'll love as a part of your very own story. A thought that provokes your mind and then inspires you to aim for the impossible, making mistakes, yet being brave.

A magic je ne sais quoi that enchants and intrigues you, moving you to feel more and to sense uniqueness.

The choice to risk it all, the one that makes you go for it, to impress yourself and all those who are worth it.

Welcome to Azimut.

AZIMUT.  
DARE TO AMAZE.





01

# THE DESIGN & LIFESTYLE ON BOARD

# FLY 60, A FLOATING OASIS OF WELLNESS

A yachting marvel of spacious abundance, the Fly 60 astonishes the senses by exploring the essence of a curated boutique hotel surrounded by endless ocean views. Intuitive designs inspire a welcoming and cleverly charming environment, elevated by refined interiors and unexpected spatial solutions. Making for an indulgent sense of relaxation, the perpetual and infinitely inspiring sea views envelop the guests, accompanying them on their onboard revel.

Pursue a getaway to greatness with the Fly 60.





Welcome aboard, ladies and gentlemen.

Let us begin the tour.





# CHIC ATTITUDE





The Fly 60 draws smooth and slender lines over the sea, elongating her agile profile for a stately sense of sophistication. Her dynamic appearance is an example of form following function, after the versatile philosophy of the balanced lifestyle she embodies. Excitement, elegance and experience come together in a rare reflection on exterior design.

# LIVE LIFE OPEN ENDED



Perfect to spend dreamy summer days, the aft part of the flybridge offers a selection of arrangements to choose from, like lounging, sunbathing or freestanding furniture.



Beyond the hard-topped hosting bar and dining, a slab of sunbathing flanks the helm to set up a variable shade outpost for the pilot's companions.

# OPEN AIR ENTERTAINING



The outdoor lounges inherit all the design aspirations of the residential interiors, but favoring comfort and carefree living over all. The essential charm of life at sea is the wonder of nature, and this is the fullest extent.



Conceived as top terrace on the sea, the flybridge is split between three distinct zones, keeping everyone together with a variety of moments to enjoy the view.





Once upon a time, the bow area was for sunbathing. Whereas now you can choose how to live this space as the day passes. Based on a simple idea, the area can be converted into a convenient outdoor lounge that's perfect for conversation in the shade of the big bimini top, or for enjoying cocktails at sunset.



# A SENSE OF FLOATING SOPHISTICATION



The cockpit feels like an extension of the main deck, adding to the abundant social area a sheltered al fresco setup. The reflective steel pillars are barely perceptible and they can deploy a curtain.

# CONNECTED WITH NATURAL LIGHT





# ABSOLUTE AESTHETIC

Architect Achille Salvagni researched the interior design to develop an authentic aura of wellbeing. The spatial composition draws on the organically formed natural essences, punctuated with bronze accents. From the architectural framework to the smallest detail, every element flows from the total vision, achieving perfect harmony.





A sea-loving design intuition interprets the multifunctional philosophy into a cozy second lounge area on the sea, enriching the all-day experience of the main deck. At mealtime, the coffee table can be raised and the extensions folded out to blossom into a dining table for six.





# COZY AT SEA



# A PLEASING PALETTE OF WARM MATERIALS

The interior décor is a dance of contrasting colors and materials. It represents a contamination of three wood varieties with different finishes, from desert-colored brushed oak to pearlescent closed-pore tay wood, embellished with 100-times-glossed solid mahogany and brass and chrome-plated steel bands.



Now, let us discover the guest accommodations.

Shall we?





[ Borrowing from home design, the owner's cabin stands out for its striking personality and one-off suspended design pieces, keeping up the play on flowing lines found in the other settings. To create this impalpable sense of harmony, over forty molds have been produced with different angles of curvature. ]





The wardrobe area and bathroom are positioned aft, in such a way as to separate the owner's cabin from the engine room for an even more silent ride. Everything on board the yacht has been designed exclusively for it, including the decorative lamps, which are produced specifically by Italian companies for this particular boat.



# ENHANCED SENSE OF SUITENESS



Homestyle furnishings preserve the charm of the cozy design below deck, offering all the storage needed to comfortably move in on long stays. The large rectangular side windows play the leading role, however, supplying the natural light that makes the owner's suite so charming.





With their huge glazed surfaces, both the VIP stateroom in the bow and the twin bed cabin are flooded with light. Meticulously finished down to the tiniest detail, they achieve the highest possible standards of comfort, to offer the most elegant of welcomes to family and friends.

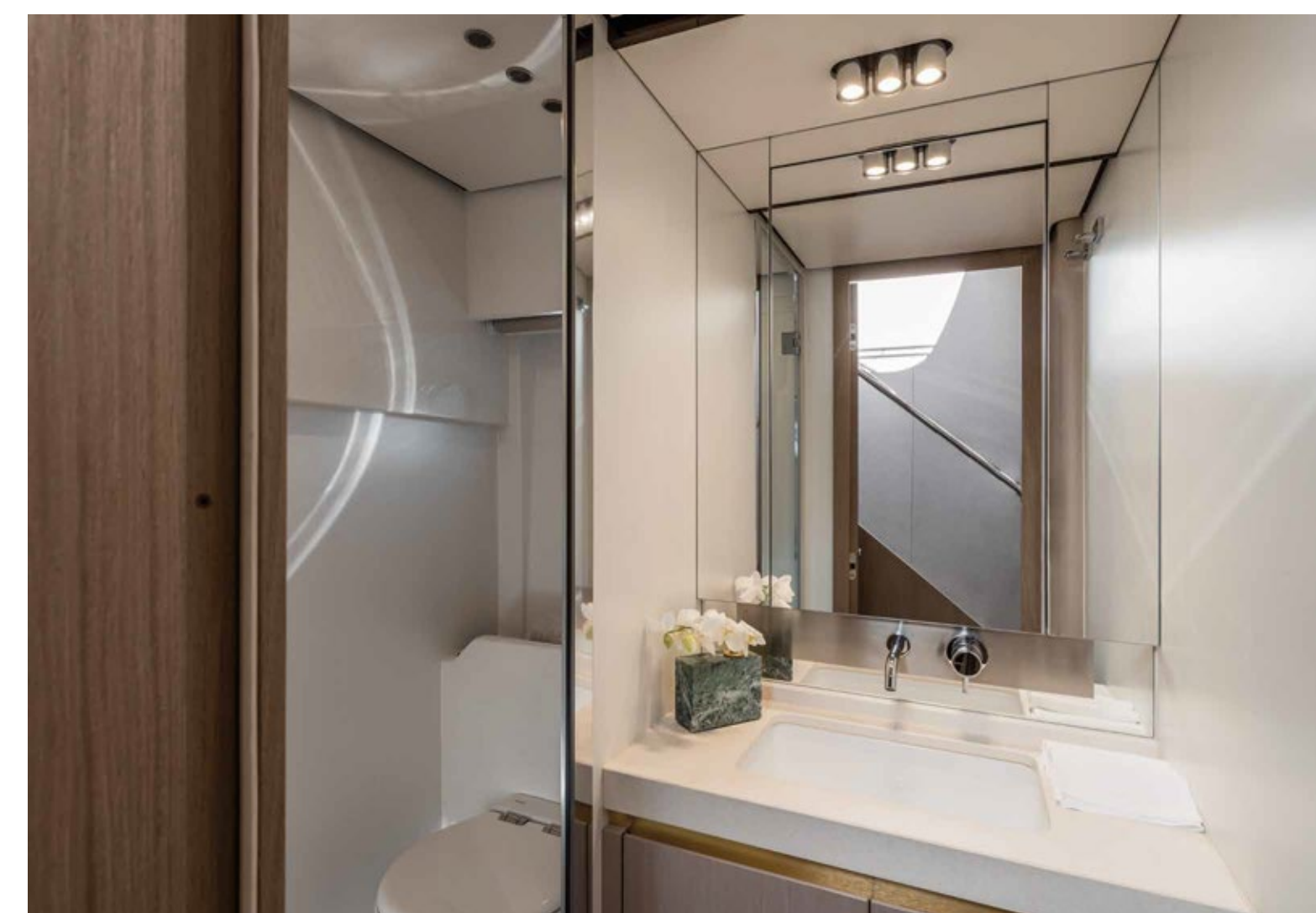

[ The flush glass displays and full suite of tools empower the pilot to manage every service on board from a comfortable seat at the helm. ]





02

# HER MAIN TECHNICAL FEATURES

The beauty of the Fly 60 is not solely a matter of exterior and interior design elements that combine to perfectly play out Azimut's essence. Her beauty is also about discovering the technological advancements and special components that contribute to making her truly unique and highly innovative.



# CARBON-TECH GENERATION

Azimut's pioneering use of carbon fiber lamination goes beyond pure performance. The Carbon Tech Generation offers expanded volumes on board, while maintaining excellent dynamic stability and perfect handling. Preserving the yacht's low center of gravity, the carbon fiber was focused on the upper parts of the yacht, lightening the laminated components by up to 30% and reducing the natural roll momentum up to 15%.

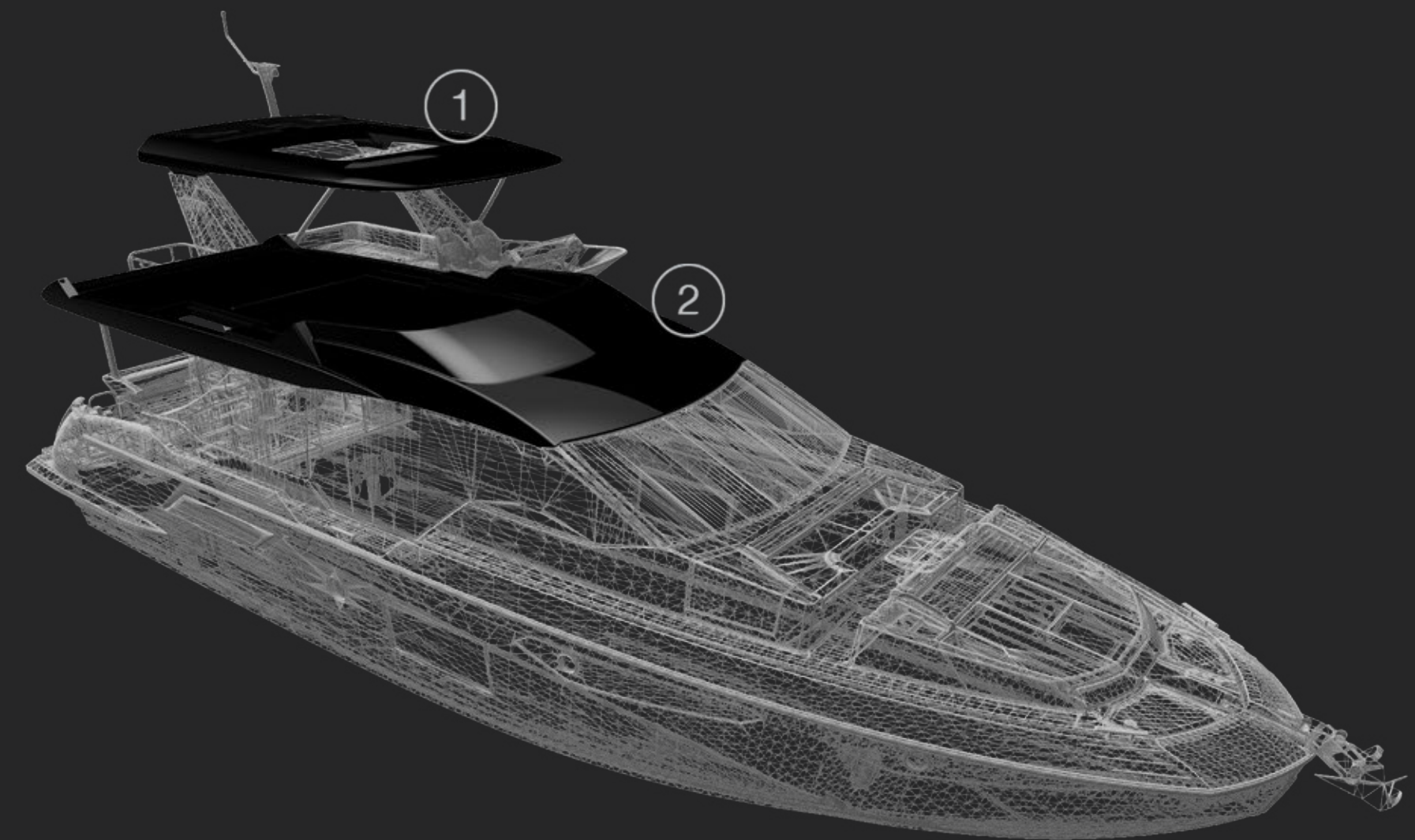

- ① HARD TOP (OPT)
- ② FLYBRIDGE



# ACTIVE TRIM CONTROL

Automated interceptors optimize the trim at every speed to maintain ideal hydrodynamics for performance and efficiency, at the same time negating any lateral imbalance due to sidewinds or weight distribution. With the pilot's peace of mind assured, the driving experience is simpler and more enjoyable.



# ELECTRONIC POWER STEERING (EPS)

At the helm, the innovative Optimus Electronic Power Steering system by Seastar Solutions gives you a similar sensation to driving a top of the range car. The steering sensitivity and resistance can be linked to speed, enhancing the pilot's control in every situation. The system also has the additional benefit of eliminating the hydraulic piping between the helm station and the rudder compartment.

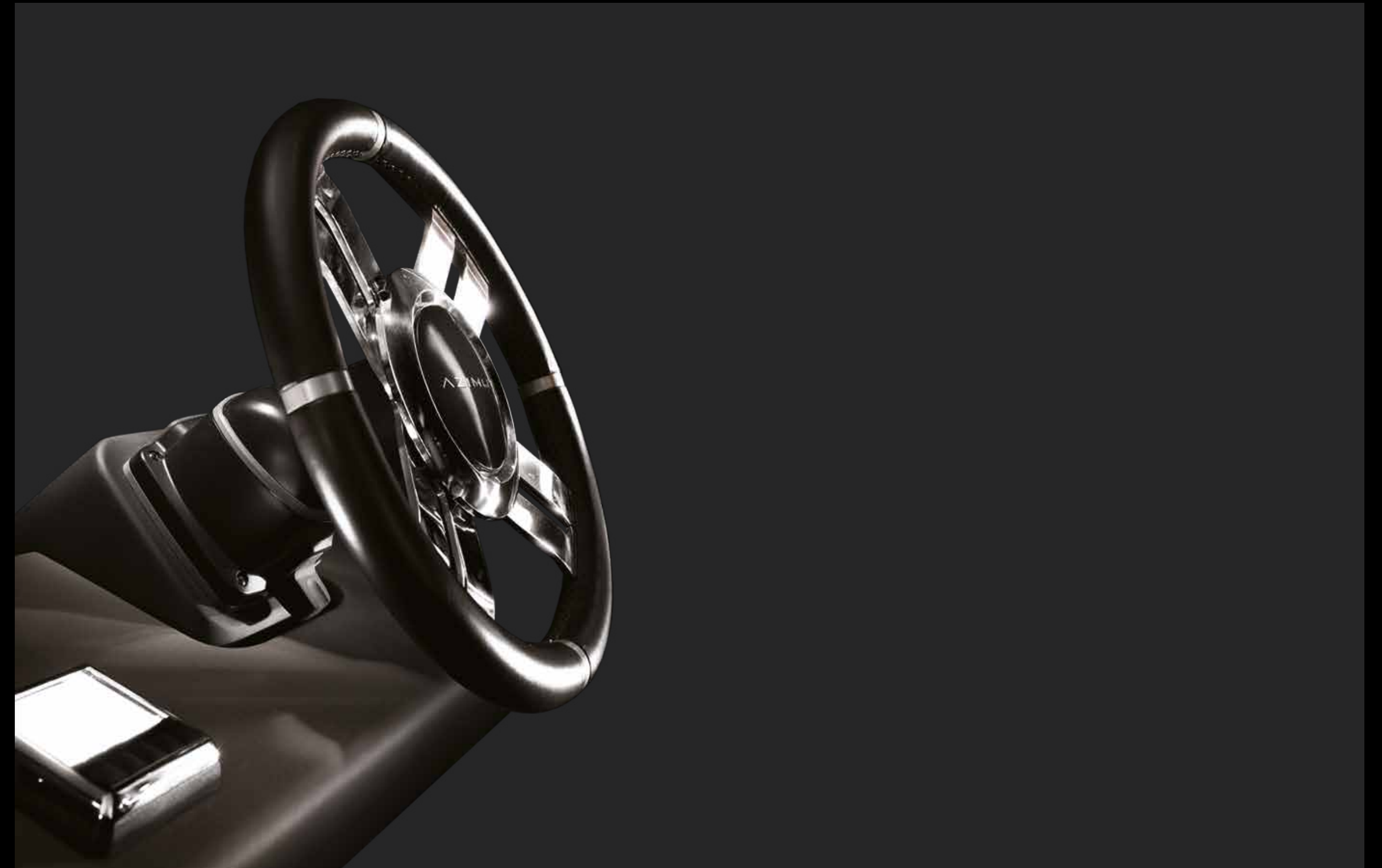



03

# FLY 60 SPEC SHEET

# GENERAL CHARACTERISTICS

LENGTH OVERALL (INCL. PULPIT)	18,25 m	59' 10"
BEAM MAX	5,05 m	16' 7"
DRAFT	1,46 m	4' 9"
DISPLACEMENT	36 t	79366 lb
ENGINES	2 x VOLVO D13 900 mHP	
MAXIMUM SPEED	up to 31 kn	
CRUISING SPEED	up to 26 kn	
KEEL	Deadrise 15,6° aft and 22° amidship	
FUEL CAPACITY	2800 l	740 US Gal
WATER CAPACITY	750 l	198 US Gal
CABINS	3 + 1 crew	
BERTHS	6 + 2 crew	
HEAD COMPARTMENTS	3 + 1 crew	
BUILDING MATERIAL	Carbon Fiber + GRP	
EXTERIOR DESIGNER	Stefano Righini	
INTERIOR DESIGNER	Achille Salvagni Architetti	
HULL DESIGNER	P.L. AUSONIO Naval Architecture & Azimut R&D Dept.	
BUILDER	Azimut Yachts	
CERTIFICATIONS	CE B; NMMA	

Last updated 08.2022  
Please consult your dealer for the latest specifications.

UNI ISO 8666  
The performance described applies to a vessel with standard configuration (standard equipment installed) and a clean hull, propellers, and rudder. It is also noted that the performance described was recorded under favourable sea and wind conditions (Beaufort scale index 1, Douglas scale index 1); different and worse sea conditions could significantly impact performance.

CE MARK  
Given the continual evolution of technology, Azimut | Benetti S.p.A reserves the right to modify the technical specifications on its vessels at any time and without prior notice.

# FLYBRIDGE

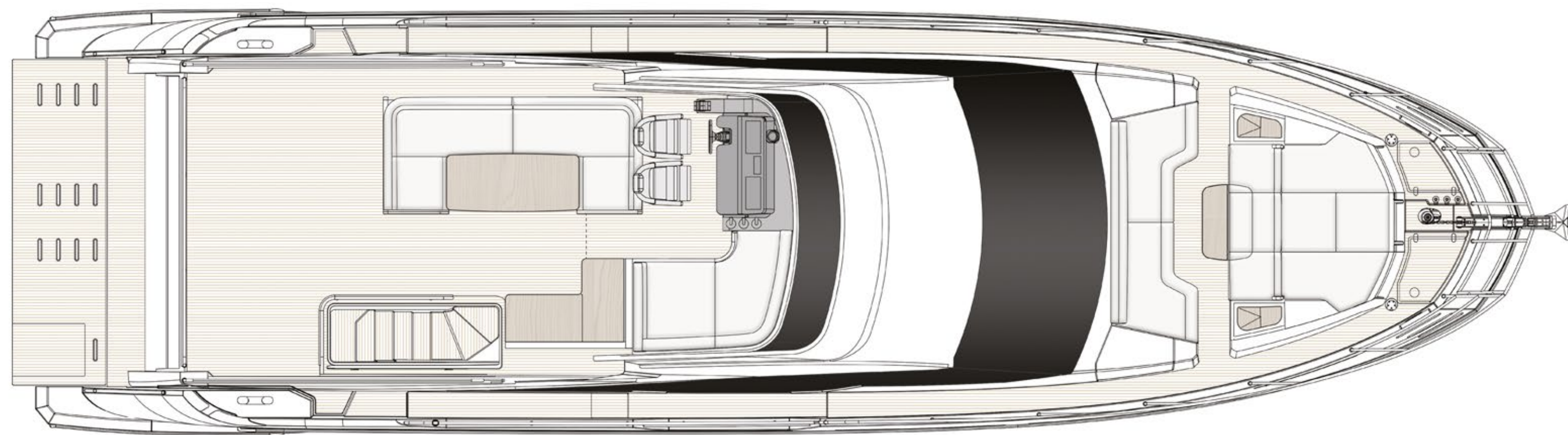

# MAIN DECK

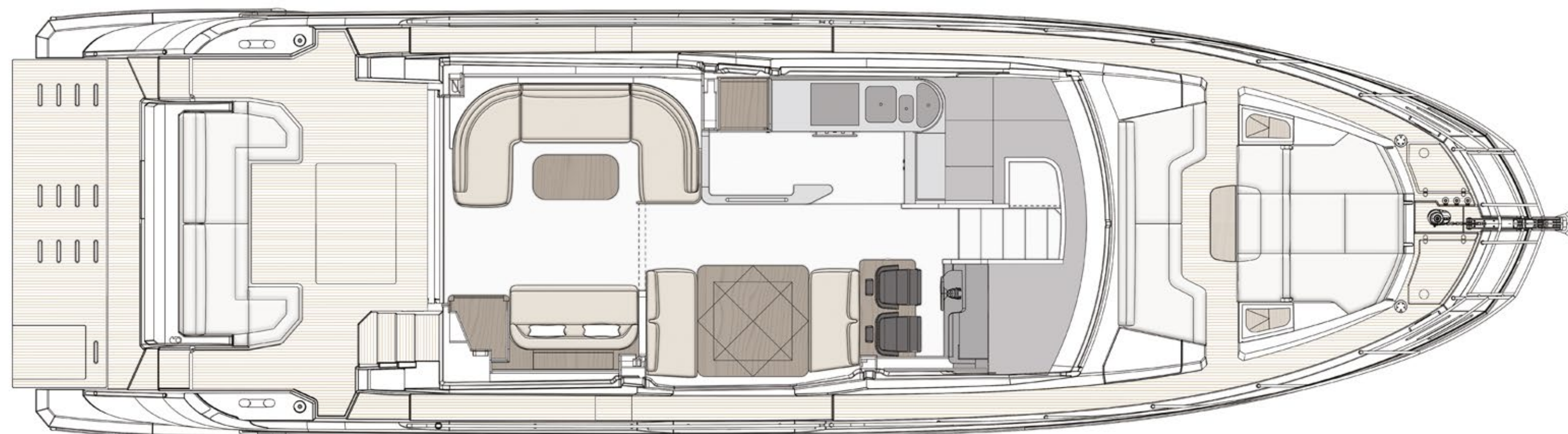

# LOWER DECK

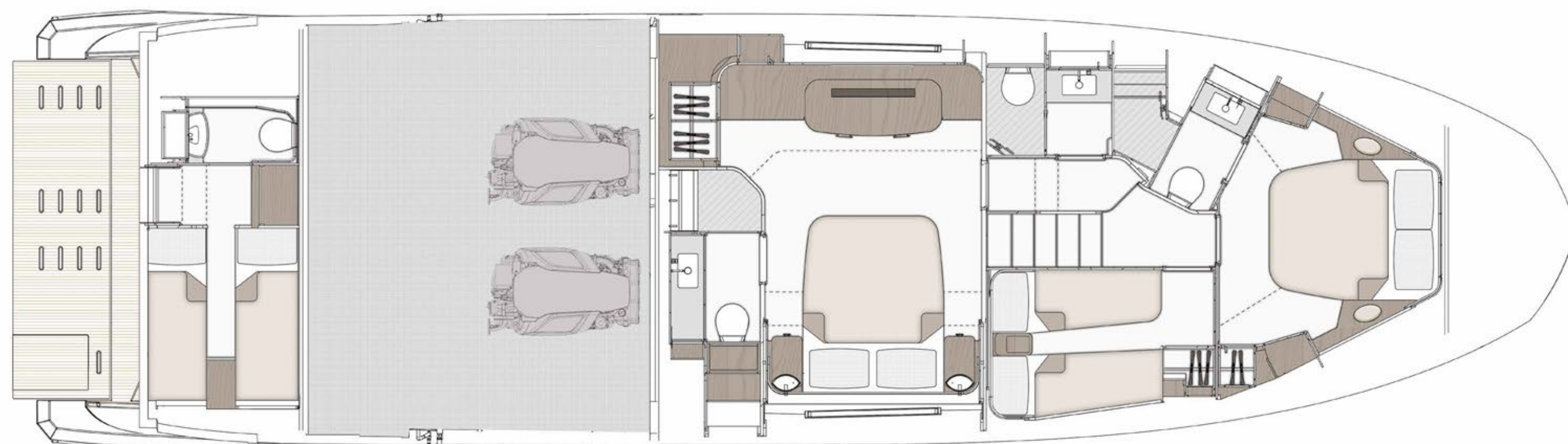



04

# THE FLY SERIES



# A VISUALLY IMMERSIVE EXPERIENCE

A barrierless and illuminated experience, the iconic Flybridge boat series was forged out of tradition to immerse its guests in the sea, while inspiring the unique feeling of open-air freedom.

Sleek and spacious all-Italian interiors are bound to create a sensational atmosphere, filling days and nights with charming comfort and lightness.

Experience yesterday's game-changer spirit upped by today's avant-garde air.

50  
53  
60  
68  
72  
78



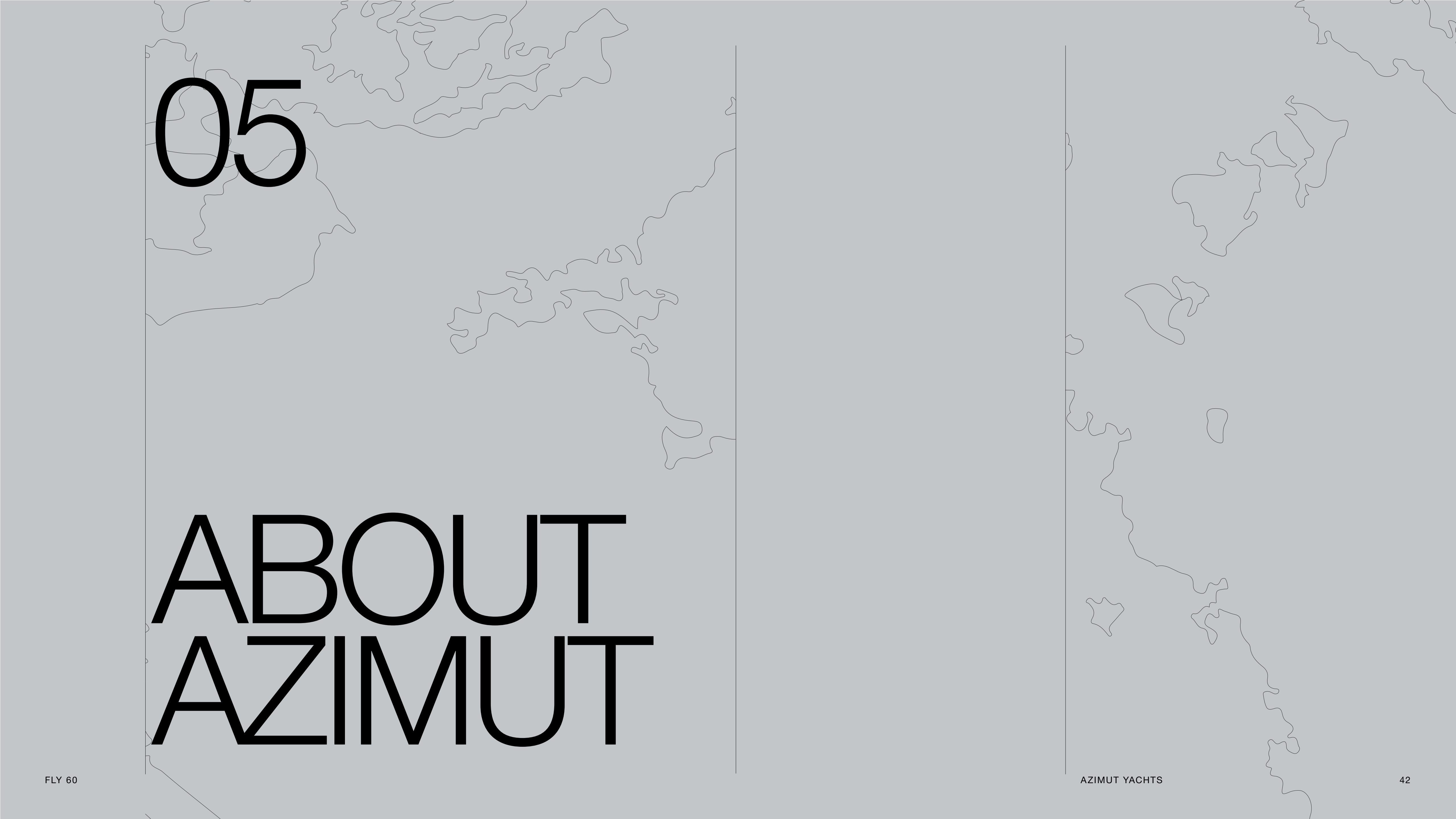

05

# ABOUT AZIMUT



# A FAMILY-MADE COMPANY CULTURE

An immense and personal passion for the sea. A clear and forward-facing attitude. A strong and relentless work ethic. Since 1969, Paolo Vitelli, the creative visionary founder and businessman behind Azimut, has been set on challenging the industry's status quo with a daring desire: bring to life an unexpected nautical experience, through yachts built to combine alluring aesthetics with construction expertise and impeccable technology.

An audacious mindset that has, over time, surprised and captivated the yachting sector, transforming Azimut into a bold and recognizable benchmark, and laying the foundation for the birth of the largest megayacht builder in the world, the Azimut | Benetti Group.

The international and management-based standing of the company today, is deeply nourished by the solid and memorable family heritage that has distinguished it from the beginning. A historically pioneering vision that enables it to continue thriving day after day, through ingenious inventions and long-term goals that look to the future with Paolo's daughter, Giovanna Vitelli.

# A SUSTAINABLE VISION TODAY, FOR TOMORROW

An avant-garde vision and a strong emotional appeal have shaped the history of Azimut as a leader in the field of nautical innovation as well as its commitment to the creation of a sustainable-oriented and attentive company culture today.

An ambitious and personal touch that has allowed Azimut to grow and evolve on both levels, embracing the challenge of a future nurtured by an eco-conscious approach to boat construction and by an authentic focus and responsibility on human well-being.





# OUR ♻️ ECO-YACHTING PHILOSOPHY

The Azimut I Benetti Group has made tangible investments to guide the Technical as well as the R&D departments toward the construction of yachts with a diminished environmental impact. Its main areas of intervention have focused on significantly lowering fuel consumption and CO2 emissions through the development of highly efficient hull designs, innovative propulsion systems and an extensive use of carbon fiber to decrease yacht weight.



# A SAFE AND HEALTHY WORK ENVIRONMENT

The forerunning shipyard of Avigliana was the first of the company's Italian shipyards to obtain the ISO 45001 certification in 2011, attesting its rigorous abidance to all occupational health and safety requirements. Recognized as the most technologically-advanced shipyard in Europe, it has also led the nautical sector revolution in terms of being among the earliest adopters of the vacuum infusion process to drive resin into a laminate, avoiding styrene emissions and therefore guaranteeing its precious workers a healthier setting.

As of 2013, all the other Italian production sites have adapted to meet the necessary requirements to obtain the ISO 45001 certification.



# A GLOBALLY-CONNECTED DEALER AND SERVICE NETWORK

---

5 SHIPYARDS

---

6 DIRECT OFFICES

---

138 OFFICIAL DEALERS

---

80 COUNTRIES

---

The highly widespread commercial network put in place by Azimut Yachts, allows the company to offer a continuous presence to its ship owners, concretely curating their demands by meeting their most specific needs.

[Find your Dealer →](#)





# THE LARGEST PRIVATE GROUP IN THE YACHTING WORLD

Azimut is part of the Azimut | Benetti Group, the biggest private player and shipbuilder in the nautical sector today. The Vitelli family, the founder and majority shareholder of the company, has been leading the way for over fifty years now, continuing to innovate through the Group's main yacht brands, Azimut and Benetti, while developing a variety of service brands to cater to the different demands of ship owners worldwide.



# OUR SHIPYARDS MAKE US PROUD

Avigliana — Italy

HQ / SHIPYARD

Savona — Italy

DELIVERY CENTRE

Viareggio — Italy

SHIPYARD / STYLING LOUNGE

Fano — Italy

SHIPYARD

Itajaí — Brazil

SHIPYARD

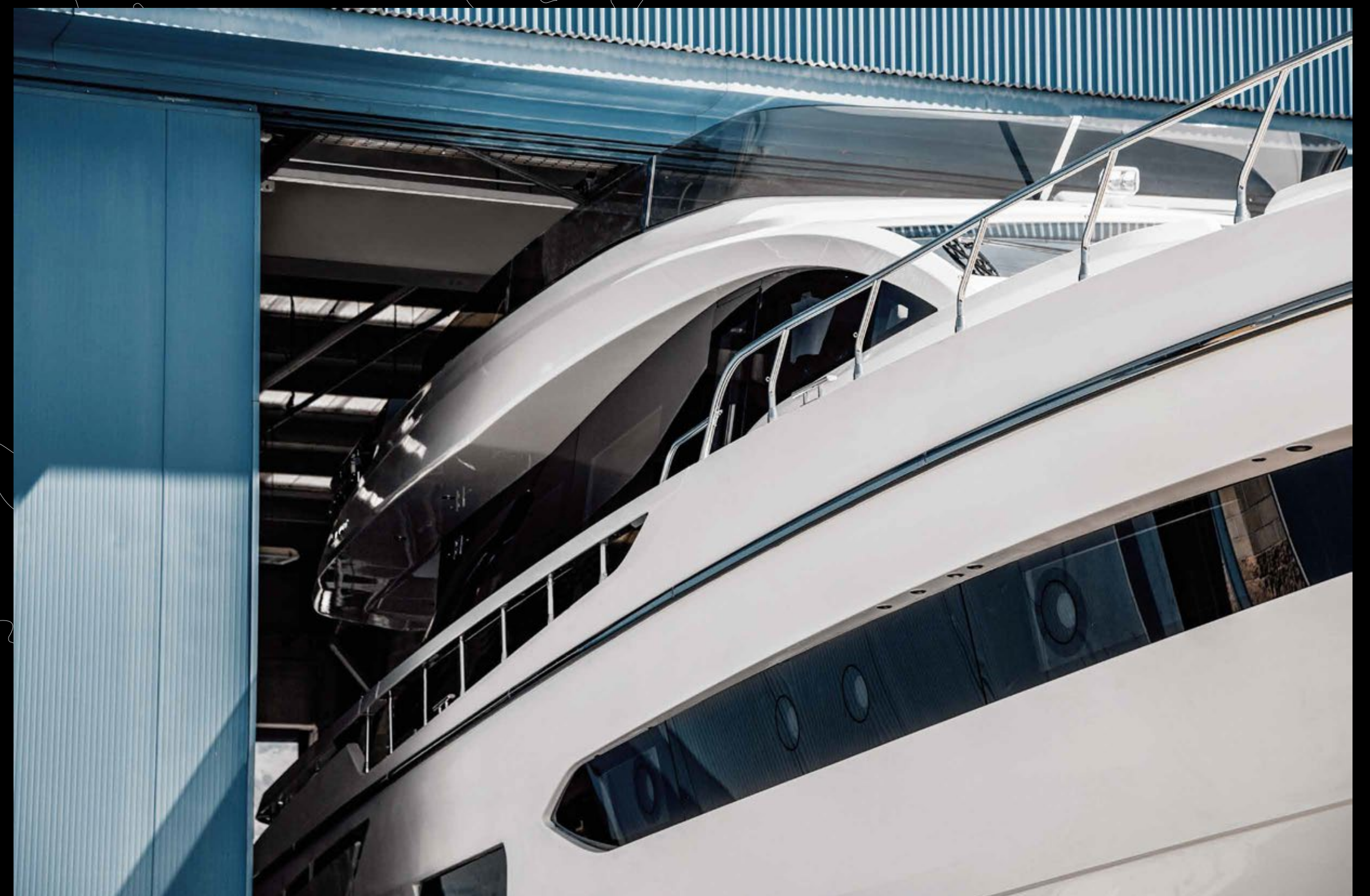



CONCEPT & DESIGN: APART  
PHOTOS: ALESSANDRO GUERRIERI, PAOLO PETRIGNANI

AZIMUT YACHTS THANKS:  
ACHILLE SALVAGNI ARCHITETTI, FRETTE

OFFICIAL PARTNER



GARMIN.

Raymarine



VOLVO  
PENTA

AZIMUT | BENETTI SPA  
VIA MARTIN LUTHER KING, 9  
10051 AVIGLIANA, TORINO  
ITALY

RELEASE 09.22

This brochure in no way constitutes a contract of sale for the boatyard's vessels to any person or company. All information contained herein, including but not limited to technical and performance data, illustrations, and drawings, is non-binding and for purposes of illustration only. The information in this brochure refers to the boatyard's standard motoryacht models available as of the date of publication. Technical and descriptive information is valid only to the extent that it pertains to the specific vessel that is the subject of a purchase. Contract terms are valid only to the extent that they are contained in a contract of sale. This document is based on information available at the time of publication. Despite efforts to ensure the greatest possible accuracy, the information contained herein may fail to cover all details, omit technical or commercial changes that may have been made subsequent to publication, describe features that are not present, and fail to envisage all circumstances that might occur. Any illustrations, photographs, diagrams and examples shown in this brochure are included solely for the purposes of illustrating the text. Due to the different features of each vessel, the boatyard assumes no liability for actual use based on the illustrated applications.

AZIMUT

[azimutyachts.com](http://azimutyachts.com)

